

- SYMBOL LEGEND**
- ⊗ EXIT LIGHT (REFER TO ELECTRICAL LIGHTING PLAN)
 - ← xx' EGRESS CAPACITY (TO EXTERIOR OR AT 2 HOUR PARTITION)
 - VISUAL FIRE ALARM (REFER TO ELECTRICAL POWER 4 SYSTEMS PLAN)
 - ⊕ VISUAL AND AUDIO FIRE ALARM (REFER TO ELECTRICAL POWER 4 SYSTEMS PLAN)
 - ⊞ MANUAL PULL STATION (REFER TO ELECTRICAL POWER 4 SYSTEMS PLAN)
 - ⊞ FIRE EXTINGUISHER CABINET (REFER TO PLUMBING FIRE PROTECTION PLAN)
 - FE FIRE EXTINGUISHER (REFER TO PLUMBING FIRE PROTECTION PLAN)
 - FV/FE FIRE DEPARTMENT VALVE CABINET (REFER TO PLUMBING FIRE PROTECTION PLAN)
 - CO2 FIRE EXTINGUISHER (REFER TO PLUMBING FIRE PROTECTION PLAN)
 - ⊙ SMOKE DETECTOR (REFER TO ELECTRICAL POWER 4 SYSTEMS PLAN)
 - ⊙ WINDOW SPRINKLER
 - ⊞ x-x' INDICATES BOUNDARY OF INDIVIDUAL SMOKE COMPARTMENT

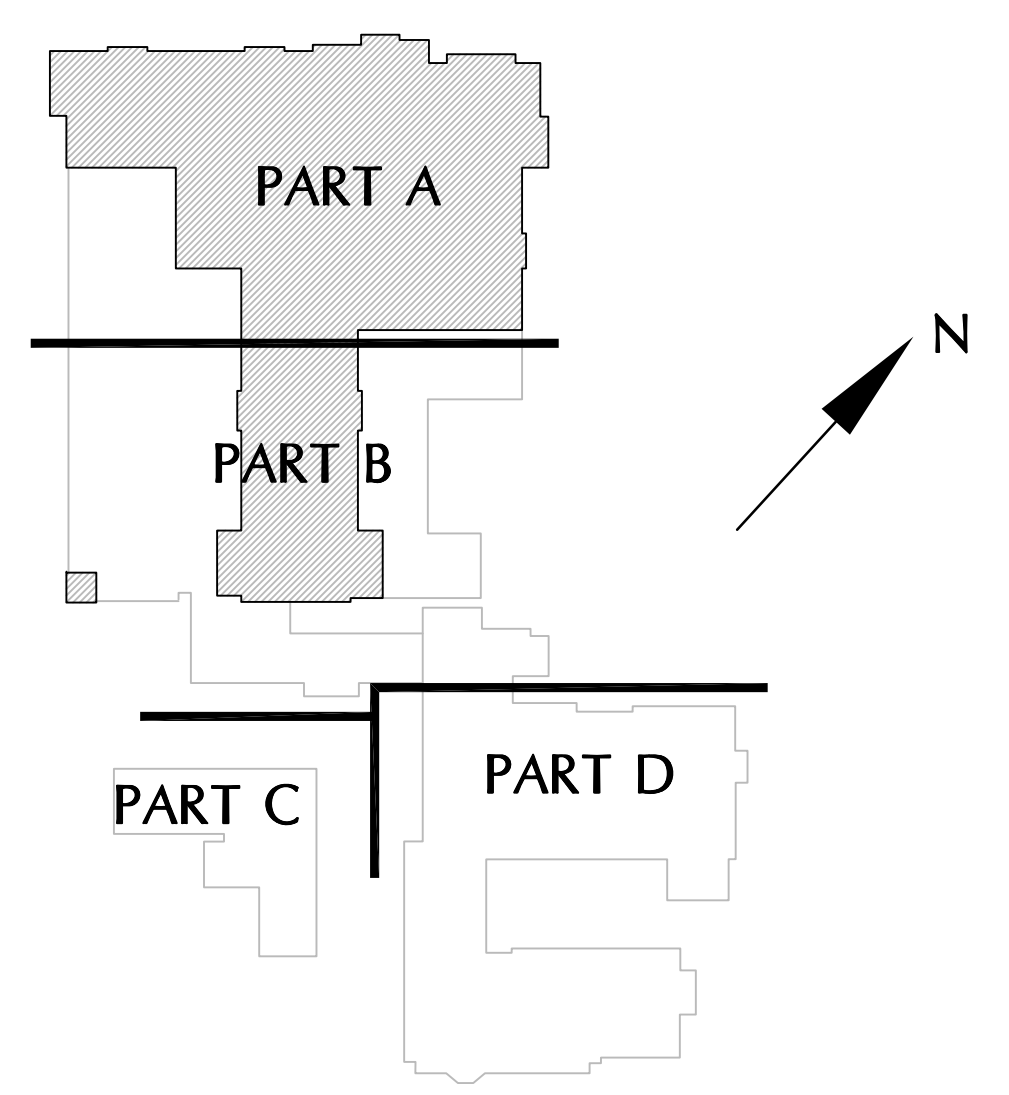

KEY PLAN

NOT TO SCALE

SECOND FLOOR LIFE SAFETY PLAN

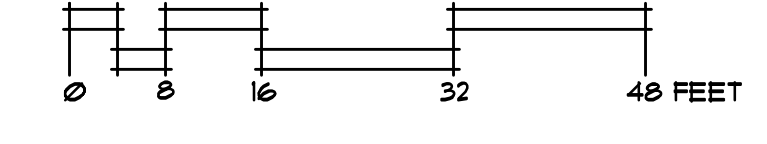

ADDITIONS AND RENOVATIONS
 MARTHA'S VINEYARD HOSPITAL
 OAK BLUFFS, MASSACHUSETTS

G320 SECOND FLOOR LIFE SAFETY PLAN

DATE: 10/23/2007
 JOB NO.: A02403
 DESIGNED BY: JD
 CHECKED BY: DC

REVISIONS:
 A. ADDENDUM #1 11/16/07